

\*Phone Luton 23151

**OFFICIAL PROGRAMME**

**Price 6d.**

FOOTBALL LEAGUE -- DIVISION 4

**Luton Town v. Southend United**

Wednesday, 12th April, 1967 Kick-off 7.30 p.m.

**WILLIAMS & RICHARDSON**

**Electrical, Radio and Television Engineers**

174, Biscot Road - - - Luton

**OFFICIAL**

**HOOVER SALES and SERVICE**

Telephone:

LUTON

26262

**POST THIS COUPON TO OUR ADDRESS ABOVE TODAY**  
*Please send me further details of the Hoover*

Name \_\_\_\_\_

Address \_\_\_\_\_

Tel No. \_\_\_\_\_

Landscape Work by

# LILLYWHITES

Grange Avenue, Leagrave, Luton

Telephone: LUTON 51441

Retail Sales Saturday only

9 am. to 4 p.m.



## ODEON

Lucky Number Draw

Three double  
Complimentary Tickets  
Free

Three Lucky Numbers will be announced at today's match. The holders will each be given a double Complimentary ticket for the Odeon Cinema, on presentation of the Programme to the Secretary's office.

Your Number is

N<sup>o</sup> 0933

Join the

## BOBBERS STAND

and

## SUPPORTERS CLUB

1/2 per year

21/- Life Membership

## BEECH HILL PATH

## LUTON, BEDS.

Telephone: Luton 29042

LUTON TOWN FOOTBALL and ATHLETIC CO., LTD.

Established 1885

Incorporated 1897

First Professional Side Season 1891 - 92

### DIRECTORS:

Chairman: T. HODGSON  
J. A. C. BAIN  
Vice-Chairman: A. F. ENGLAND  
L. S. HAWKINS  
H. RICHARDSON  
Manager: ALLAN BROWN  
Secretary: R. READHEAD  
Hon. Solicitor: E. WALLER  
Honorary Medical Officer: Dr. E. J. CRARER, M.B., Ch.B.  
Auditors: KEENS, SHAY, KEENS & Co., Chartered Accountants, Luton

### Club Notes

OUR visitors tonight, Southend United, are paying their first visit to Kenilworth Road since November, 1964, when we met them here twice in a fortnight.

First encounter was in an F.A. Cup-tie which we won 1-0 and, a fortnight later, Southend reversed the score in a League match.

Tonight, both teams urgently need points for vastly differing reasons. Fact that our team have collected only one point from the last ten at stake has served to revive the fear that we might finally be concerned in the re-election issue, a bogey that we seemed to have laid a few short weeks back.

Since then, injuries have been a considerable handicap to Manager Allan Brown and although the position has improved slightly, we have not been at full strength for some considerable time.

On the other hand, Southend are very much in the fight for promotion to regain the Third Division place they lost at the end of last season.

From this match, and from the return at Southend on Monday week, they will be looking for vital points, but our team's home record has been such this season, that we have high hopes of two points this evening.

Then, on Saturday, comes another tough task against another promotion-chasing team, Barrow, who have the best away record in the Fourth Division, and who gained the full quota of points over

the Easter holiday to press home their claims.

Earlier in the season, we went down 3-0 on their Holker Street ground, but last season, when Barrow paid their first - ever visit to this ground, the result was an exciting 3-2 victory for us.

A similar result on Saturday would be very pleasing and we are hoping for a bigger than average crowd to see this successful combination.

Unfortunately, our young wing-half, Alan Slough, will not be taking part in any of the remaining matches this season.

He is due to go into hospital for a cartilage operation and his sights now must be fixed on a return to complete fitness for the start of next season.

The ball for tonight's match has been donated by Mr. H. Goldman, licensee of the Star Inn, Chalton, who is interested in both teams in that he was formerly at the Peter Boat Inn, Leigh-on-sea.

Other offers of footballs from local firms or individuals will be warmly welcomed.

TODAY'S FOOTBALL

was kindly donated by

Mr. H. GOLDMAN

"THE STAR,"

CHALTON

late of "PETER BOAT"

LEIGH - ON - SEA

## LUTON TOWN FOOTBALL CLUB POOL

FOOTBALL RESULTS FOR SATURDAY, 8th APRIL, 1967—Week 4—Colour Green

£100 3 Highest Scores 12 Goals 6 Dividends Winners receive £16/13/4 each  
 £50 3 Next Highest Scores 11 Goals 31 Dividends Winners receive £1/12/3 each  
 £40 3 Most Against 13 Goals 1 Dividend Winner receives £40  
 £25 Accumulator Not won carried forward to week 5

### LUTON TOWN FOOTBALL CLUB IMPROVEMENT FUND—Week 4

	£25	£5	£5	£5	£2	£2	£2
Monday	17762	18654	23746	13826	02735	15451	24214
Tuesday	11281	19445	04601	28275	14008	00933	21399
Wednesday	16586	08492	29055	03874	12693	10608	25203

## W. CHAMBERLAIN

& CO., (LUTON) LTD.

VALSPAR *General*  
 Lacquer and Flat Wall Paint *Hardware*

SISSON'S *Merchants*  
 Sicolina Distemper \*

PARIPAN *ALL GARDEN REQUISITES*  
 Enamels and Water Paint

106, Dunstable Road, Luton

Telephone 20329 Enquiries Invited

## MOTORISTS

Up to 50 per cent No Claim Bonus

WHY PAY CASH

Your Insurance covered from  
 £1 deposit and 20 weekly payments  
 Open all Day Saturday

ALL ENQUIRIES TO

**JOHN FIELDING**  
 & CO. (INSURANCE) LTD.

WELLINGTON HOUSE  
 STUART STREET, LUTON

Telephone: LUTON 30627

Immediate Attention for ALL Enquiries

Keep Right on Top

**'RONS'** Gentlemen's  
 Hairdressers  
 and Stylists

6, MILL STREET, LUTON

Telephone Luton 21961

Also at 127, High St, North, Dunstable

Telephone: Dunstable 62063

★ 7 CHAIRS OPERATING ★

INTERNATIONAL STAFF

Private

Hire Purchase

can be arranged on

Cars, Motor - Cycles

etc. from 1959 upwards Apply—

**JOHN FIELDING**

& Co. (Insurance) Ltd.

Wellington House, Stuart Street

Luton Telephone 30627/819

## PEN PORTRAITS OF OUR VISITORS

**Trevor Roberts** (goalkeeper). Born in Caernarvon, North Wales and has a number of Welsh Amateur Caps to his credit. Joined Liverpool and played in the reserve side for two years before being transferred to Southend United in January, 1966. Holds a Liverpool University Degree in Geography.

**Tony Bentley** (full back). Born Trent Vale. Joined Southend from Stoke City as a right winger in 1961, later reverted to half back and has now again successfully changed into full back.

**Graham Birks** (full back). Signed from Peterborough United in January, 1966. Was previously with Sheffield Wednesday. Born Sheffield.

**Mel Slack** (wing half). Born Bishop Auckland. Signed from Sunderland, his only previous professional club in August 1965. Fine attacking wing half, has also played inside forward

**Eddie May** (centre half). Born Epping, Essex. Previously played as an amateur with Dagenham Football Club until he signed as a professional for Southend United in January, 1965. Stepped into the centre half spot last season and has shown a tremendous amount of improvement in this position.

**Tony Beanland** (wing half). Signed from Southport in March, 1966, previously with Blackpool. Strong attacking wing half with excellent distribution. Born Bradford.

**Derek Woodley** (winger). Born Isleworth Middlesex. Previous club West Ham United. Signed for Southend United in August 1963. One of the fastest wingers in the Third and Fourth Divisions, and has a particularly powerful shot.

**Ray Smith** (inside right). Born Islington, London. Joined Southend as an amateur and signed professional forms in Decem-

ber 1961. Powerfully built inside forward with tremendous stamina and strong shot. Second highest scorer last season.

**Eddie Firmiani** (centre forward). Born South Africa. Played for Charlton before being transferred to Italy where he played for Sampdoria Inter-Milan and Genoa before returning to Charlton for two seasons. Was signed for Southend in May 1965. Very talented player who was United's top scorer last season, playing 36 League games.

**Andy Smillie** (inside forward). Born Minster. Previous professional clubs West Ham United, Crystal Palace and Scunthorpe United, from whom he was signed in May, 1965. Has played inside forward, left wing and left half.

**John McKinven** (winger). Signed on a free transfer from Raith Rovers in 1960. Ball playing winger who has always retained a First Team spot during his service with Southend United. Born Campbelltown, Scotland.

## Forthcoming Matches

Thursday, April 20th. Kick-off 7.30 p.m.  
 Seaward Trophy Final  
**LUTON SCHOOLS v. N. HERTS**

Saturday, April 22nd. Kick-off 3 p.m.  
**Wm. Pease Jubilee Trophy Final**

Wednesday, April 26th. Kick-off 7.30 p.m.  
**North Home Counties**  
**Sunday Football League Cup Final**

Saturday, April 29th. Kick-off 3 p.m.  
 Football League—Division 4  
**LUTON TOWN v. LINCOLN CITY**

**Charles  
Mares**  
LIMITED

65, GEORGE STREET

A great choice  
of good Clothes

for MEN and BOYS

6, KING STREET

LUTON

LUTON TOWN

Colours — Black and White

		2 Read Goal		3 Jardine	
	4 Thomson		5 Dougan	6 Moore	
7 French	8 Allen	9 Rioch	10 Whittaker	11 King	

Referee : Mr. R. A. PAYNE (Hounslow)

Linesmen :

Red Flag : Mr. K. E. Teaves (Charlbury) Orange Flag : Mr. S. F. Lover (London)

11 McKinven	10 Ingle	9 Flatt	8 Smith	7 Woodley
	6 Beanland	5 May	4 Slack	
	3 Birks		2 Bentley	
		Goal Roberts		

SOUTHEND UNITED

Colours—Blue and White

SUBSTITUTES : Luton Town — Johnson Southend United — Smillie



Pick Flowers  
Brewmaster

For

High Class Colour Work  
and Printing of  
Every Description  
on the Latest Machines

Try

**E. A. ALLEN & SON**

(Luton) LTD. 'Phone : Luton 51626

2a, DOUGLAS ROAD

Printers of this Programme

INDUSTRIAL and  
HOME HEATING

also all types of ELECTRICAL  
INSTALLATIONS

CONSULT

**ENGINEERING  
SERVICES** (LUTON)  
LTD.

Arcade Chambers, 16a, Leys Avenue  
Letchworth. 'Phone: Letchworth 5341

LUTON F.C. — for FOOTBALL

**COSTIN'S  
FOR COACHES**

29 - 52 Seater Luxury Coaches for  
Private Hire

Excursions to away fixtures

**G. E. COSTIN Ltd.**

67, West Street, Dunstable

'Phone 64331

*Spifford*

Direct  
from  
Factory  
at

**Factory Price  
Saves £'s**

Your Local Agency Showroom

OFFERS —

1. A Free Home / Business Consultancy  
Service 9 a.m. to 9 p.m. without  
obligation.

Manager Mr. Fennell and Showroom  
Representative Mr. Thorarinnson. Our  
Fully Trained Estimators and Planners  
will call by appointment.

2. High class full-time Fitting Service,  
at reasonable prices, under exclusive  
Contract to this Showroom.

3. Free Literature and Samples of  
complete range always available.

This is the only Showroom Display  
of Cyril Lord Carpet in the area

14, LEAGRAVE ROAD

LUTON

Tel.: 24164

**Twenty - One  
Eighty - Seven  
Three**

These three numbers appeal to me

Try them on the telephone  
when you want a taxi home

Tel.: Luton 21873

**S.A.S. TAXI SERVICE**

PRIVATE HIRE

## LEAGUE MATCHES—Players' Appearances and Goal Scorers

Names	APPEARANCES			GOALS		
	1st Team	2nd Team	'A' Team	1st Team	2nd Team	'A' Team
ADAMSON	1	24	25	...	6	6
ALLEN	7	...	...	2	...	...
BEAVEN	...	12	25	...	...	5
CONBOY	12	12	...	1	2	...
DOUGAN	19	...	...	...	...	...
FRENCH	29	...	...	4	...	...
GRIEVE	...	12	...	...	...	...
JARDINE	39	...	...	...	...	...
JOHNSON	5	18	16	...	7	8
KEVAN	11	...	...	4	...	...
KING	18	15	...	4	2	...
LAMB	...	3	...	...	...	...
LUNNISS	1	3	...	...	...	...
MOONEY	...	16	28	...	...	3
MOORE	37	2	...	2	...	...
NICHOLSON	...	19	...	...	...	...
PLEAT	28	4	...	5	...	...
READ	29	11	...	...	1	...
RIDDICK	31	2	...	4	...	...
RIOCH, B.	30	2	...	8	2	...
RIOCH, N.	...	20	28	...	1	11
RIVERS	13	21	...	1	...	...
SLOUGH	30	6	...	2	...	...
SWAN	14	...	...	...	...	...
THEAR	13	11	...	5	3	...
THOMSON	36	...	...	...	...	...
WHITTAKER	36	...	...	6	...	...
YARDLEY	1	5	...	...	1	...
AMATEURS	...	64	189	...	2	13
OPPONENTS	...	...	...	1	1	...

One Kick  
and you're away  
on a  
**VESPA**  
from  
**GRAYMAC**  
**AUTOS LTD.**  
Dunstable Place  
LUTON  
THE  
**Vespa People**  
LUTON 31381

THE  
**Old Bell**  
HARPENDEN  
(FULLY LICENCED)



Proprietor:  
**TOM HODGSON**  
Ex-Captain, Luton Town F.C.  
Large Car Park

**REIDS**  
Chemists  
(LUTON) LTD.

For ALL your  
PHARMACUTICAL  
TOILET and  
PHOTOGRAPHIC  
REQUIREMENTS  
169, Dunstable Rd.  
LUTON  
Corner of Kenilworth Rd.  
Phone - LUTON 21766



LATE LICENCE  
UNTIL 2 a.m.

Telephone  
LUTON 51357 for  
Membership  
application form and  
details of forthcoming  
attractions

**VISIT**  
**CÉSAR'S**  
**LUTONS LEADING**  
**NIGHT SPOT**  
**DANCING**  
**DINING**  
**CASINO**

TOP STAR CABARET  
Week Commencing **SUNDAY, 9th APRIL, 1967**

**RONNIE HILTON**  
Week Commencing **MONDAY, 17th APRIL, 1967**

**BOB MONKHOUSE**

C'ESAR'S ANNOUNCE  
new all-star cabaret every Sunday

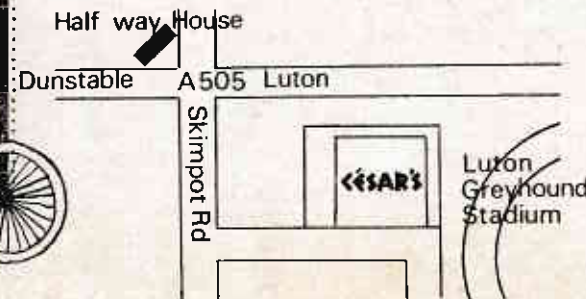

## Today's Half-Time Scores

NOTE: The letter in the Programme corresponds with the letter on the Board—thus A 0-1 means that the first named club has scored 0 and their opponents 1

### FIRST LIST

A  
B  
C  
D  
E  
F  
G  
H  
K  
L  
M  
N

## FOOTBALL LEAGUE — DIVISION FOUR

Up to and including Saturday, 8th April, 1967

	P	W	D	L	F	A	Pts
Stockport Co	38	22	10	6	55	30	54
Southport	40	20	11	9	62	38	51
Barrow	40	20	11	9	67	46	51
<b>SOUTHEND UTD.</b>	<b>39</b>	<b>20</b>	<b>8</b>	<b>11</b>	<b>64</b>	<b>44</b>	<b>48</b>
Crewe Alex.	38	18	11	9	59	44	47
Tranmere Rov.	38	18	11	9	50	52	47
Hartlepoons	40	20	6	14	58	56	46
Brentford	38	16	12	10	52	47	44
Wrexham	38	12	18	8	63	51	42
Aldershot	40	15	11	14	64	54	41
Bradford City	40	16	9	15	61	55	41
Chesterfield	38	15	7	16	53	51	37
Port Vale	37	13	11	13	44	43	37
Barnsley	40	11	13	16	53	57	35
Exeter City	39	11	13	15	43	54	35
Notts County	38	12	9	17	47	58	33
Halifax Town	37	11	11	15	46	55	33
Newport Co	38	9	14	15	45	54	32
Chester	40	11	10	19	47	73	32
<b>LUTON TOWN</b>	<b>39</b>	<b>12</b>	<b>7</b>	<b>20</b>	<b>48</b>	<b>68</b>	<b>31</b>
Rochdale	38	11	8	19	42	61	30
Bradford	39	10	8	21	45	71	28
York City	38	9	9	20	55	65	27
Lincoln City	38	8	10	20	22	46	26

### SECOND LIST

A  
B  
C  
D  
E  
F  
G  
H  
K  
L  
M  
N

## LONDON MID - WEEK LEAGUE

Up to and including Friday, 7th April, 1967

	P	W	D	L	F	A	Pts
Q.P.R.	24	16	6	2	63	21	38
Millwall Athletic	24	17	4	3	74	27	38
Charlton Ath.	25	16	6	3	59	21	38
Colchester Utd.	24	12	6	6	42	44	30
Aldershot	21	7	3	11	38	51	17
Watford	24	7	3	14	36	51	17
Southend United	23	5	3	14	39	53	13
Leyton Orient	23	4	3	16	19	55	11
<b>LUTON TOWN</b>	<b>25</b>	<b>4</b>	<b>2</b>	<b>19</b>	<b>28</b>	<b>75</b>	<b>10</b>

## SOUTH EAST COUNTIES LEAGUE

Up to and including Saturday, 8th April, 1967

	P	W	D	L	F	A	Pts
Charlton Ath	27	19	5	3	73	32	43
Ipswich Town	28	18	4	6	61	36	40
Chelsea	28	15	5	8	79	50	35
Millwall Athletic	26	15	4	7	49	30	34
Tottenham Hotspur	25	13	5	7	57	35	31
Crystal Palace	29	12	7	10	65	55	31
Leyton Orient	25	11	7	7	43	34	29
Q.P.R.	27	11	5	11	53	41	27
Watford	24	9	7	8	57	49	25
Brentford	28	11	2	15	46	64	24
Fulham	24	9	5	10	45	49	23
West Ham United	27	10	3	14	44	50	23
Bexley United	24	7	5	12	56	68	19
Brighton	27	6	3	18	29	71	15
Arsenal	27	6	2	19	34	62	14
<b>LUTON TOWN</b>	<b>28</b>	<b>5</b>	<b>1</b>	<b>22</b>	<b>46</b>	<b>103</b>	<b>11</b>

### THIRD LIST

A  
B  
C  
D  
E  
F  
G  
H  
K  
L  
M  
N

## Division 4 and London Mid-Week League Fixtures : 1966 - 67

1966	First XI Div. 4	Attendance	F	A	1966	London Mid - Week League	Attendance	F	A
Aug. 20 Sat.	Halifax Town	6149	H	2 0 1	Sept. 8 Thur.	Q.P.R.	395	H	0 6
27	Brentford	6769	A	0 1	13	Charlton Athletic		A	1 5
Sept. 3	Newport County	5377	H	3 1 3	22	Southend Utd.	287	H	1 5
6 Tues.	Rochdale	2472	A	0 3	Oct. 6	Aldershot	344	H	4 1
10 Sat.	Barnsley	2188	A	1 2	11 Tues.	Watford		A	0 3
17	Stockport Co.	5887	H	0 2	26 Wed.	Leyton Orient		A	0 1
24	Aldershot	4471	H	4 0	Nov. 3 Thur.	Colchester Utd.	249	H	1 3
29 Thur.	Rochdale	6435	H	3 1	10	Millwall Ath.	280	H	1 2
Oct. 1 Sat.	Wrexham	6887	A	0 2	14 Mon.	Millwall Ath.		A	0 2
8	Southport	4385	A	1 4	22 Tues.	Q.P.R.		A	1 8
15	Notts County	5743	H	2 5	30 Wed.	Southend United		A	1 7
20 Thur.	Bradford City	4150	H	0 0	Dec. 14 Wed.	Aldershot		A	1 2
23 Sat.	Chester	5751	A	0 0	21	Watford	215	H	1 3
24 Mon.	Newport County	3456	A	0 2	1967				
29 Sat.	Bradford	4566	H	2 2	Jan. 12 Thur.	Leyton Orient	163	H	5 0
Nov. 5 Sat.	Port Vale	3502	A	0 1	25 Wed.	Southend Utd.	321	H	2 0
12	Crewe Alex.	4785	H	2 1	31 Tues.	Charlton Athletic		A	0 3
16 Wed.	Bradford City	3097	A	1 2	Feb. 15 Wed.	Leyton Orient	296	H	2 2
19 Sat.	Barrow	5061	A	0 3	21 Tues.	Watford		A	2 3
26	Cup-1 Exeter City		A	1 1	Mar. 1 Wed.	Aldershot	329	H	3 1
Dec. 1 Thur.	F.A. Cup 1 - Replay				7 Tues.	Q.P.R.		A	0 4
	Exeter City	7079	H	2 0	15 Wed.	Colchester Utd.	393	H	1 2
3 Sat.	Lincoln City	3893	A	1 8	22	Millwall Ath.		A	0 6
10	Chesterfield	5096	H	3 2	29	Q.P.R.	337	H	0 2
17	Halifax Town	3622	A	1 1	April 3 Mon.	Colchester United		A	0 0
26 Mon.	Tranmere Rovers	6806	A	0 1	5 Wed.	Millwall Ath.	274	H	1 4
27 Tues.	Tranmere R.	9123	H	2 0	12 Wed.	Southend United		A	
31 Sat.	Brentford	8531	H	3 0	17 Mon.	Aldershot		A	
1967					19 Wed.	Charlton Ath.		H	
Jan. 7 Sat.	Cup-2 Bristol Rovers		A	2 3	May 1 Mon.	Leyton Orient		A	
14	Barnsley	8287	H	1 1	3 Wed.	Colchester United		A	
20 Fri.	Stockport County	9555	A	0 1	10 Wed.	Watford		H	
Feb. 4 Sat.	Aldershot	5375	A	1 4	To be arranged	Charlton Ath.		H	
11	Wrexham	6551	H	3 1					
18	Exeter City (4)	3744	A	1 2					
25	Southport	6903	H	0 0					
Mar. 4	Notts County	3909	A	2 1					
11	Exeter City (5)	6046	H	4 0					
18	Chester	6982	H	1 0					
24 Fri.	Hartlepoons United	8442	A	1 2					
25 Sat.	York City	1912	A	1 5					
27 Mon.	Hartlepoons Utd.	7370	H	0 2					
April 1 Sat.	Port Vale	5413	H	1 1					
8	Crewe Alex. (6)	5124	A	1 3					
12 Wed.	Southend Utd.		H						
15 Sat.	Barrow		H						
22	Bradford		A						
24 Mon.	Southend United		A						
29 Sat.	Lincoln C. (S.F.)		H						
May 6	Chesterfield		A						
13	York City		H						
20	Final								

## NEXT MATCHES

Saturday, 15th April, 1967

Football League — Division 4 Kick-off 3 p.m.

Luton Town  
v  
**BARROW**

Prices of Admission : Centre Stand 7/6  
Wing Stand 6/- Enclosure 5/- Boys 2/6  
Bobbers Stand 4/- Boys 2/- Terraces 4/- Boys 2/-

Wednesday, 19th April, 1967

London Mid Week League Kick-off 7.30 p.m.

Luton Town Reserves  
v  
**Charlton Res.**

PRICES OF ADMISSION  
Grandstand and Enclosure Only  
Adults 2/6 Children 1/6 Centre Stand 6d. extra

# **WILDS** OF LUTON LTD. OF DUNSTABLE LTD. OF BEDFORD LTD.

---

SUPPLIERS TO LUTON TOWN F.C.

---

The finest 3 sports stores in the County

---

## CALLING ALL SPORTSMEN

Come and see our wonderful range of Summer Sports Goods :—

**TENNIS : CRICKET : BOWLS : ARCHERY  
FISHING TACKLE : GOLF : ATHLETIC, Etc.**

Special Club Discount

A fine selection of Binoculars from £7

**Tennis Rackets Repaired and Re-strung at short notice**

Sports Clothing by—

**SLAZENGER : FRED PERRY : BUKTA**

Swimming Costumes and Trunks by—

**JANTSEN : ENGLISH ROSE : SPEEDO**

**The finest selection of Camping Equipment for miles**

Tents by—

**La Prairie : Marechal : Raclet : Vango : Armac : P.T.C.  
Andre Jamet : Erve, etc.**

Call and see our Outdoor

**CAMPING EXHIBITION at CRANFIELD, Nr. Bedford**

April 4th - 23rd, over 100 erected Tents

---