

Phone Luton 23151

OFFICIAL PROGRAMME

Price 6d.

FOOTBALL LEAGUE — DIVISION IV

Luton Town v. Crewe Alexandra

Wednesday, 24th April, 1968 Kick-off 7.30 p.m.

WILLIAMS & RICHARDSON

Electrical, Radio and Television Engineers

174, Biscot Road Luton

OFFICIAL

HOOVER SALES and SERVICE

Telephone:

LUTON

26262

POST THIS COUPON TO OUR ADDRESS ABOVE TODAY
Please send me further details of the Hoover.....

Name

Address

Tel No.

LILLYWHITE (Leagrave) LTD.

Timber and Fencing Specialist

LARCHLAP : LARCHLINE : LARCHWEAVE
PINE-RAIL : PINE-BOARD : PINE-PAIL
INTERWOVEN

Hire Purchase terms arranged

Call or telephone Luton 52140

TRADE or RETAIL Monday to Friday 8 a.m. to 5.30 p.m.
Saturdays 8 a.m. to 4.30 p.m.

ODEON Lucky Number Draw Three double Complimentary Tickets Free

Three Lucky Numbers will be announced at today's match. The holders will each be given a double complimentary ticket for the Odeon Cinema, on presentation of the Programme to the Secretary's office.

Your Number is

1971
No

Supporters Club Notes

The 'Player of the Year' elected by poll of the Junior Section is our Captain TERRY BRANSTON, after a close Poll. The date for the presentation of the Trophy has not yet been fixed, but watch these notes for details.

It is hoped to extend this popular voting for the 'Player of the Year' award to all members. Thus giving the adult members an opportunity of selecting their choice.

A celebration will be organised for members to mark the gaining of promotion by our team. Details will be announced later.

A new supply of Team photos are on hand—get yours today—the team who got us out of Division IV.

Please ask the mobile sellers for these or any soccer needs.

Our welcome tonight to supporters of Crewe Alexandra—may they see a good game.

LUTON TOWN FOOTBALL and ATHLETIC CO., LTD.

Established 1885

Incorporated 1897

First Professional Side Season 1891 - 1892

DIRECTORS :

Chairman : T. HODGSON
Vice-Chairman : A. F. ENGLAND
J. A. C. BAIN R. I. BURR B. G. ENGLAND L. S. HAWKINS A. T. HUNT H. RICHARDSON
Secretary : R. READHEAD
Manager : ALLAN BROWN
Honorary Medical Officer : C. J. BUCKINGHAM, M.B.
Honorary Dentist : A. HARGREAVES
Honorary Solicitor : E. WALLER
Auditors : Messrs. KEENS, SHAY, KEENS & Co., Chartered Accountants, Luton

Club Notes

THIS, of course, is a great occasion for us because the team go into the match with Crewe Alexandra knowing that they have already achieved promotion and that a point tonight will make certain that the title comes to Luton.

That will put an end to the mathematical calculations that have been going on these last weeks about what is needed to bring home the major prize.

Many weeks ago, Manager Allan Brown came firmly to the belief that to finish on top was well within the compass of the ability of the team and he has been proved absolutely right.

How right, can be seen from the fact that we go into this with 18 consecutive unbeaten games behind us and the next aim is to set up a new record for the aggregate of points in the Fourth Division.

At present, that is held by Peterborough United, with 66 and five more points will enable us to establish a new high.

With three home matches left, there seems no earthly reason why that should not be achieved and it is something on which the manager has very much set his heart.

Crewe, of course, have every intention of accompanying us into Division III, so a thriller can be expected because obviously, to gain their ambition, they must gain some reward, either from this meeting, or from the one at Southend on Friday, so these are an extremely vital few days for them.

Saturday's opponents, Bradford City, too, are in the hunt, so there should be another big crowd to welcome them.

In this respect, with supporters please note that the "Football League Review" which will be included in the programme on Saturday, will have a colour photograph of the Luton team. In anticipation of a heavy demand, extra copies have been ordered and there should be sufficient to supply the needs of everyone.

In the course of preparation at the moment, is a glossy, souvenir programme which will incorporate the highlights of the past season and also the match programme for the last game of the season with Brentford and which will be on sale on Saturday, 11th May, 1968, price 2/6.

TODAY'S PIC



ALLAN BROWN

LUTON TOWN FOOTBALL CLUB POOL

BINGO

£60—Full House in 40 Numbers or Less

£40—Full House in 44 Numbers or Less

£25—Full House in 50 Numbers or Less

£25—Full House in 54 Numbers or Less

NUMBERS PRINTED DAILY in DAILY SKETCH AND ALL LOCAL PAPERS

LUTON TOWN IMPROVEMENT FUND—Week 1

	£15	£5	£5	£2	£2	£2
Monday	21382	03356	19248	13203	09652	11171
Tuesday	18469	15693	00534	08868	12047	15439
Wednesday	20468	06555	10833	22608	07026	01673

WINNING CAR NUMBERS—Week 7 Mauve—17111—If not claimed within 14 days
Week 5 Moss Green—11835 or Week 10 Blue—25511 or Week 10 Blue—25559

W. CHAMBERLAIN & CO., (LUTON) LTD.

VALSPAR *General*
Lacquer and Flat Wall Paint *Hardware*

SISSON'S *Merchants*
Siscolin Distemper ★

PARIPAN *ALL GARDEN*
Enamels and Water Paint *REQUISITES*

106, Dunstable Road, Luton
Telephone 20329 Enquiries Invited

Keep Right on Top

'RONS' Gentlemen's
Hairdressers
and Stylists

6, MILL STREET, LUTON
Telephone: Luton 21961

Also at 127, High St. North, Dunstable
Telephone: Dunstable 62063

★ 7 CHAIRS OPERATING ★
INTERNATIONAL STAFF

SAM-PAN

Chinese Food to Take Away

16, Leagrave Road

LUTON

NOW OPEN

NOW OPEN

Week 1—Colour Green

PEN PORTRAITS OF OUR VISITORS

Willis Mailey (goalkeeper). A former Scottish Schoolboy International who started his career with Everton before moving to Cresty Road on the 15th March, 1963. Made his League debut during the 1963/64 season. Although on the small side makes up for his lack of inches with his agility. An ever present this season and has played over 150 times for the First Team. Born Glasgow.

Tommy Lowry (full back). Formerly with Liverpool and now in his second season with the Club. Came into the League side last season but injury kept him out of the side for some time. This season has only missed one game. A very consistent performer.

Peter Leigh (full back). Captain of the side. Born Altrincham. Now in his seventh season with the Club after former service with Manchester City. Soon established a First Team place and has now played in over 250 First Team games all of which have been in the left back position. A very popular member of the side.

Keith Stott (wing half). Joined the Crewe staff as an amateur during 1964/65 season and signed full time forms the same season. Started his career as a centre half but has been appearing regularly at wing half with the occasional game at centre forward. Recently made his 100th First Team appearance.

Eric Barnes (centre half). The longest serving member of the side having been with the Club since 1958. This season broke the appearance record which has stood for over 30 years.

Mick Gannon (wing half). Formerly with Everton and Scunthorpe United. Joined the Crewe staff during the 1964/65 season and has held a regular First Team place throughout. Played in all League games last season and an ever present so far this season. A very popular member of the staff. Over 100 First Team games. Born Liverpool.

Kevin McHale (winger). Joined the Club in January from Huddersfield Town, his only previous Club where he gave many years of faithful service. A clever ball player who has proved to be a most useful player.

Don Ratcliffe (inside forward). Although Don has only recently moved to Crewe he has proved his versatility having played at outside left, right half and right back. A very experienced player who has been with Stoke City, Grimsby Town and Darlington.

John Regan (centre forward). Formerly with Shrewsbury Town and Brentford. Was a regular member of the League side for some time but has only recently regained a First Team place.

Gordon Wallace (inside forward). Son of a former Scottish International who joined the Crewe staff from Liverpool late in 1967 at a record fee for the Club. A very skillful player who is now scoring consistently. A popular member of the staff.

Billy Dearden (winger). Formerly with Oldham Athletic, came to Crewe in December 1965. Usually plays at outside right but has recently played at centre forward with success. A striker with an eye for goals.

TODAY'S FOOTBALL.

was kindly donated by

RON and BERYL

Licensees

GREYHOUND

PARK STREET WEST, LUTON

TODAY'S LINE-UP

Luton Town

Colours—

White and Black

- | | |
|---------------|-------------------|
| 1. Read | Referee : |
| 2. Dougan | Mr. B. H. DANIELS |
| 3. Jardine | (Rainham) |
| 4. Slough | |
| 5. Branston | Linesmen : |
| 6. Moore | Red Flag : |
| 7. French | Mr. R. A. LONG |
| 8. Buxton | (Northampton) |
| 9. Allen | Orange Flag : |
| 10. Rioch | Mr. K. E. TEAVES |
| 11. Whittaker | (Oxford) |

SUBSTITUTE

12. McDerment

Crewe Alexandra

Colours—

All Red

- | |
|--------------|
| 1. Mailey |
| 2. Lowry |
| 3. Leigh |
| 4. Stott |
| 5. Barnes |
| 6. Gannon |
| 7. McHale |
| 8. Ratcliffe |
| 9. Regan |
| 10. Wallace |
| 11. Dearden |

SUBSTITUTE

**WHITBREAD
TANKARD**
cool, refreshing flavour



GOOD EVENING FOOTBALL NEWS & COMMENT NIGHTLY

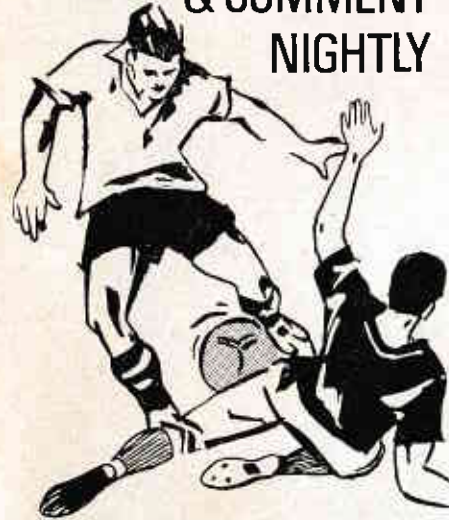

EVENING **POST**

**Twenty - One
Eighty - Seven
Three**

These three numbers appeal to me

Try them on the telephone
when you want a taxi home

Tel.: Luton **21873**

S.A.S. TAXI SERVICE

PRIVATE HIRE

For
good quality
printing
in 1968 at
reasonable
prices



COME TO

E. A. ALLEN & SON

(Luton) LTD. 'Phone: Luton 51626

Printers of Quality

2a, **DOUGLAS ROAD**

Printers of this Programme

**INDUSTRIAL and
HOME HEATING**

also all types of **ELECTRICAL
INSTALLATIONS**

CONSULT

**ENGINEERING
SERVICES** (LUTON)
LTD.

Arcade Chambers, 16a, Leys Avenue
Letchworth. 'Phone: Letchworth 5341

LUTON F.C. — for FOOTBALL

**COSTIN'S
FOR COACHES**

29 - 52 Seater Luxury Coaches for
Private Hire

Excursions to away fixtures

G. E. COSTIN Ltd.

67, West Street, Dunstable

'Phone 64331

LEAGUE MATCHES—Players' Appearances and Goal Scorers

Names	APPEARANCES			GOALS		
	1st Team	2nd Team	'A' Team	1st Team	2nd Team	'A' Team
K. ALLEN	41	14
K. BEAVEN	1	7	25	6
T. BRANSTON	42	5
M. BROWN	12	20	...	2	10	...
I. BUXTON	34	13
P. DENTON	4	10	3	...
M. DOUGAN	36	1
G. FRENCH	27	3	...	5
T. HARE	12	21
R. GREEN	9	18	...	3	17	...
F. JARDINE	37
B. JOHNSON	2	12
B. McDERMENT	19	12
P. MOONEY	...	19	30	...	2	2
J. MOORE	41	3
T. READ	39	1
B. RIOCH	40	20
N. RIOCH	...	24	29	5
J. RYAN	10	17	...	1	3	...
A. SLOUGH	31	4	...	5	1	...
A. STARLING	...	3	25
W. TAYLOR	3	13
R. WAINWRIGHT	...	19	28	...	6	16
R. WHITTAKER	34	8
TRIALISTS	8	41	5	...
AMATEURS	...	33	205	...	2	16
OPPONENTS

One Kick
and your'e away
on a
VESPA
from
GRAYMAC
AUTOS LTD.
Dunstable Place
LUTON
THE
Vespa People
LUTON 31381

THE
Old Bell
HARPENDEN
(FULLY LICENCED)



Proprietor:
TOM HODGSON
Ex-Captain Luton Town F.C.
LARGE CAR PARK

REIDS
Chemists
(LUTON) LTD.

For ALL your
Pharmaceutical
Toilet and
Photographic
Requirements

169 Dunstable Rd.
LUTON
Corner of Kenilworth Rd.
Phone - LUTON 21760

VISIT

←←ÉSAR'S

LUTONS LEADING NIGHT SPOT

DANCING DINING CASINO

LATE LICENCE
UNTIL 2 a.m.

Telephone
LUTON 51357 for
Membership
application form and
details of forthcoming
attractions

TOP STAR CABARET

APRIL 21st to 27th

THE CHANTS

APRIL 28th to May 2nd

LIONEL BLAIR AND HIS ENTIRE SHOW

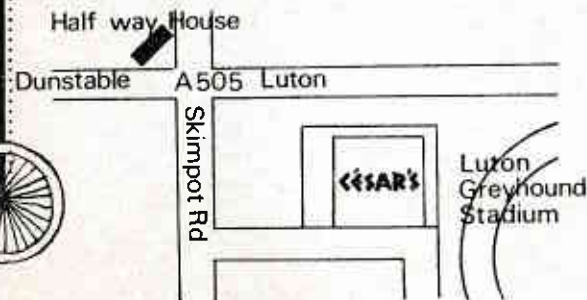

Today's Half - Time Scores

NOTE. The letter in the Programme corresponds with the letter on the Board—thus A 0 - 1 means that the first named club has scored 0 and their opponents 1

FIRST LIST

A
B
C
D
E
F
G
H
K
L
M
N

SECOND LIST

A
B
C
D
E
F
G
H
K
L
M
N

THIRD LIST

A
B
C
D
E
F
G
H
K
L
M
N

League Tables 1967 - 68

FOOTBALL LEAGUE — DIVISION FOUR

Up to and including Saturday, April 20th, 1968

	P	W	D	L	F	A	Pts
LUTON TOWN	42	25	12	5	79	38	62
CREWE ALEX.	43	19	17	7	72	44	55
Barnsley	42	21	12	9	59	42	54
Bradford City	43	22	9	12	66	47	53
Hartlepoons Utd.	42	23	9	11	54	45	53
Southend United	42	19	13	10	71	52	51
Chesterfield	43	19	11	13	66	47	49
Aldershot	43	16	16	11	63	51	48
Wrexham	42	17	12	13	65	51	46
Doncaster Rov.	41	16	12	13	59	53	44
Brentford	42	17	7	18	57	57	41
Halifax Town	41	13	15	13	49	46	41
Newport County	41	14	12	15	52	56	40
Swansea Town	41	15	10	16	61	69	40
Lincoln City	42	14	9	19	62	63	37
Darlington	42	11	15	16	45	51	37
Port Vale	42	11	14	17	59	68	36
Notts County	41	12	11	18	47	72	35
York City	42	11	12	19	59	59	34
Rochdale	42	10	14	18	47	66	34
Exeter City	42	11	12	19	44	64	33
Chester	42	9	13	20	55	73	31
Workington	42	9	11	22	51	82	29
Bradford	41	4	14	23	29	73	22

LONDON MID - WEEK LEAGUE

Up to and including Wednesday, 3rd April, 1968

	P	W	D	L	F	A	Pts
Watford	25	11	6	8	61	47	28
Millwall Athletic	22	9	7	6	52	41	25
Aldershot	23	12	1	10	42	45	25
Charlton Ath.	26	9	7	10	47	65	25
Q.P.R.	24	9	6	9	52	47	24
Colchester Utd.	23	8	6	9	45	45	22
LUTON TOWN	24	10	2	12	45	53	22
Southend United	25	8	5	12	50	51	21

SOUTH EAST COUNTIES LEAGUE

Up to and including Saturday, April 20th, 1968

	P	W	D	L	F	A	Pts
Q.P.R.	27	22	2	3	89	36	46
Orient	27	19	4	4	92	34	42
Chelsea	26	18	3	5	80	43	39
Tottenham Hotspur	28	16	4	8	78	45	36
Charlton Athletic	27	15	5	7	67	43	35
West Ham United	27	13	8	6	72	47	34
Ipswich Town	28	17	2	9	65	30	34
Crystal Palace	28	15	2	11	75	70	32
Millwall Athletic	27	10	9	8	63	37	29
Brighton	28	8	6	14	58	87	22
Fulham	28	8	4	16	38	76	20
LUTON TOWN	29	7	4	18	45	93	18
Watford	28	3	11	14	41	59	17
Oxford United	28	6	3	19	42	90	15
Gillingham	28	3	6	19	37	77	12
Bexley United	26	2	3	21	34	109	7

Division 4 and London Mid-Week League Fixtures : 1967 - 68

1967	First XI	Div. 4	Attendance	F	A
Aug. 19	Sat.	Wrexham	9514	A	1 1
.. 26	Sat.	Barnsley	7887	H	2 0
Sept. 2	Sat.	Swansea Town	6674	A	2 2
.. 4	Mon.	Southend United	11355	A	0 3
.. 9	Sat.	Hartlepoons Utd.	8347	H	1 0
.. 16	Sat.	Newport County	4625	A	1 1
.. 23	Sat.	York City	7977	H	3 1
.. 27	Wed.	Southend United	13332	H	3 1
.. 30	Sat.	Rochdale	1884	A	2 2
Oct. 3	Tu.	Doncaster Rovers	5529	A	0 2
.. 7	Sat.	Chester	3967	A	3 1
.. 14	Sat.	Chesterfield	10441	H	1 0
.. 21	Sat.	Exeter City	3434	A	5 0
.. 25	Wed.	Doncaster Rovers	13925	H	5 3
Nov. 11	Sat.	Workington	10935	H	4 0
.. 15	Wed.	Swansea Town	14975	H	4 0
.. 18	Sat.	Lincoln City	6052	A	3 2
.. 25	Sat.	Halifax Town	11572	H	2 0
Dec. 2	Sat.	Bradford City	7957	A	0 2
.. 14	Th.	Oxford C. (Cup 1)	11394	A	2 1
.. 16	Sat.	Wrexham	9598	H	2 1
.. 23	Sat.	Barnsley	8704	A	2 2
.. 26	Tu.	Bradford	16699	H	2 0
.. 30	Sat.	Bradford	3674	A	1 2
1968					
Jan. 6	Sat.	Cup 2—Swindon	18203	A	2 3
.. 13	Sat.	Hartlepoons Utd.	4728	A	1 2
.. 20	Sat.	Newport County	10992	H	1 1
.. 27	Sat.	Port Vale (3)	5970	A	0 0
Feb. 3	Sat.	York City	2747	A	1 1
.. 10	Sat.	Rochdale	10040	H	4 1
.. 17	Sat.	Brentford (4)	7752	A	2 0
.. 24	Sat.	Lincoln City	11159	H	4 2
.. 26	Mon.	Darlington	13948	H	3 1
Mar. 2	Sat.	Chesterfield	14075	A	0 0
.. 9	Sat.	Port Vale (5)	12749	H	2 0
.. 16	Sat.	Exeter City	12409	H	0 0
.. 20	Wed.	Aldershot	9724	A	1 0
.. 23	Sat.	Darlington	4336	A	2 1
.. 30	Sat.	Aldershot (6)	10618	H	3 1
April 6	Sat.	Workington	2195	A	1 0
.. 12	Fri.	Notts County	16631	H	2 0
.. 13	Sat.	Chester	13266	H	0 0
.. 15	Mon.	Notts County	7920	A	2 2
.. 20	Sat.	Halifax Town	5091	A	1 0
.. 24	Wed.	Crewe Alexandra		H	
.. 27	Sat.	Bradford C. (S F)		H	
May 4	Sat.	Crewe Alexandra		A	
.. 11	Sat.	Brentford		H	
.. 18	Sat.	F.A. Cup (Final)			

1967 London Mid - Week League Attendance F A

Aug. 30	Wed.	Colchester United		A	0 1
Sept. 6	Wed.	Colchester United	332	H	1 0
.. 20	Wed.	Watford	465	H	1 4
Oct. 11	Wed.	Millwall Athletic		A	1 3
.. 18	Wed.	Charlton Athletic	627	H	6 2
Nov. 7	Tues.	Charlton Athletic		A	1 3
.. 22	Wed.	Southend United	997	H	2 3
.. 28	Tues.	Watford		A	1 5
Dec. 6	Wed.	Q. P. R.	332	H	2 5
.. 19	Tues.	Q. P. R.		A	3 4

1968					
Jan. 17	Wed.	Colchester United		A	2 1
.. 24	Wed.	Aldershot	586	H	3 0
.. 29	Mon.	Southend United		A	1 5
.. 31	Wed.	Colchester United	718	H	3 0
Feb. 7	Wed.	Millwall Athletic		A	0 4
.. 12	Mon.	Aldershot	429	H	2 1
.. 14	Wed.	Q. P. R.	805	H	3 2
.. 20	Tues.	Charlton Athletic		A	1 2
.. 28	Wed.	Charlton Athletic	428	H	1 0
Mar. 5	Tues.	Q. P. R.		A	3 1
.. 7	Th.	Aldershot		A	2 3
.. 13	Wed.	Watford	440	H	2 0
.. 27	Wed.	Southend United	686	H	2 2
Apr. 3	Wed.	Southend United		A	2 2
.. 10	Wed.	Millwall Athletic	585	H	4 0
.. 30	Tues.	Watford		A	
May 2	Thur.	Aldershot		A	
.. 6	Mon.	Millwall Athletic		H	

The figures 1, 2, 3, 4, 5, 6, refer to Cup Tie Dates
Copyright of the Football League Limited 1967

NEXT MATCHES

Saturday, 27th April, 1968

Football League -- Division 4 Kick-off 3 p.m.

LUTON TOWN

Bradford City

PRICES OF ADMISSION : Centre Stand 7/6
Wing Stand 6/- Enclosure 5/- Boys 2/6
Bobbers Stand 4/- Boys 2/- Terraces 4/- Boys 2/-

Monday, 6th May, 1968

London Mid Week League Kick-off 7.30 p.m.

Luton Town Reserves
v.
Millwall Reserves

PRICES OF ADMISSION
Grandstand and Enclosure Only
Adults 2/6 Children 1/6 Centre Stand 6d. extra

WILDS OF LUTON LIMITED

8-10, BUTE STREET, LUTON. Tel. 23671

WILDS OF DUNSTABLE LIMITED

41, HIGH STREET NORTH, DUNSTABLE. Tel. 63275

WILDS OF BEDFORD LIMITED

7, HIGH STREET, BEDFORD. Tel. 59834

Suppliers to—

LUTON TOWN F.C. : BEDFORD TOWN F.C.
and other Premier Clubs in the County

Now is the time to buy

your Summer Sports Equipment

We have our new season stocks available of—

CRICKET, TENNIS and BOWLS CLOTHING—FOOTWEAR and EQUIPMENT
our Representative will call and see Club Secretaries (generous Club terms)
why wait and possibly pay more Purchas Tax

Our 1968 Camping Catalogues now available

Come and discuss your requirements with our experts.

Immediate H.P. Credit facilities to approved clients

We can erect any Tent for your consideration

RIDGE TENTS from £3/0/0

FRAME TENTS (to sleep 4) from £35/10/0

Come and see the famous—

SWEDISH "PALMA DEL SOL" FRAME TENT—EXCEPTIONAL VALUE

Limited quantity imported. Now on show in our Luton shop

SLEEPING BAGS, TABLES, CHAIRS, COOKING STOVES, AIR BEDS, CAMP
BEDS—Everything for the Family or Hike Camper

Note the dates of our Camping Exhibitions

College of Aeronautics, Cranfield—B.557 (2 miles off M.1.)

Friday, April 12th (Good Friday) to Sunday, 28th April

Laporte's Sports Ground, Luton Road, Dunstable

Friday, 3rd May to Sunday, 19th May

Kensworth Sports Ground—off A5 to Whipsnade Zoo

Friday 24th May to Sunday, 9th June

Stotfold Football Ground, Stotfold, Beds.—½ mile off A1

Friday, 14th June to Sunday, 30th June