

Phone Luton 23151

OFFICIAL PROGRAMME

Price 6d.

FOOTBALL LEAGUE—DIVISION IV

Luton Town v. Bradford City

Saturday, 27th April, 1968

Kick-off 3 p.m.

WILLIAMS & RICHARDSON

Electrical, Radio and Television Engineers

174, Biscot Road

Luton

OFFICIAL

HOOVER SALES and SERVICE

Telephone:

LUTON

26262

POST THIS COUPON TO OUR ADDRESS ABOVE TODAY
Please send me further details of the Hoover

Name _____

Address _____

Tel No _____

LILLYWHITE (Leagrave) LTD.

Timber and Fencing Specialist

LARCHLAP : LARCHLINE : LARCHWEAVE
PINE - RAIL : PINE - BOARD : PINE - PAIL
INTERWOVEN

Hire Purchase terms arranged

Call or telephone Luton 52140

TRADE or RETAIL Monday to Friday 8 a.m. to 5.30 p.m.
Saturdays 8 a.m. to 4.30 p.m.

ODEON

Lucky Number Draw Three double Complimentary Tickets Free

Three Lucky Numbers will be announced at today's match. The holders will each be given a double Complimentary ticket for the Odeon Cinema, on presentation of the Programme to the Secretary's office.

Your Number is

No 00491

Supporters Club Notes

CONGRATULATIONS to Manager and Team on obtaining for us the Championship of the Fourth Division we now look forward to next season and further success — well done lads.

Last Saturday those of us who were at Halifax will never forget the feeling we had when success was ours after all the past disappointing seasons. Luton Town supporters can now hold their heads high again.

We are getting a special Championship Pennant made for sale at 3/- each. These will be on sale on the last match of the season. Get this souvenir before they are all sold.

Today our friends from Bradford City are here—a special welcome to their Junior Section who I understand play ours today.

LUTON TOWN FOOTBALL and ATHLETIC CO., LTD.
Established 1885 : Incorporated 1897 : First Professional Side Season 1891 - 1892

DIRECTORS :

Chairman : T. HODGSON : Vice - Chairman : A. F. ENGLAND
J. A. C. BAIN R. I. BURR B. G. ENGLAND L. S. HAWKINS A. T. HUNT H. RICHARDSON
Secretary : R. READHEAD : Manager : ALLAN BROWN
Honorary Medical Officer : C. J. BUCKINGHAM, M.B.
Honorary Dentist : A. HARGREAVES : Honorary Solicitor : E. WALLER
Auditors : Messrs. KEENS, SHAY, KEENS & Co., Chartered Accountants, Luton

Club Notes

CERTAINLY, the winning of the championship could not have been clinched in more fitting style than it was against Crewe Alexandra when the team put on their most brilliant display for weeks in winning 4-0.

More than that, there was the biggest crowd for several years, 18,904, to see the historic occasion and we hope that this is the measure of the support we can expect next season in our new career in the Third Division.

The fans did the players proud and everybody connected with the Club was particularly impressed with the way in which the majority of the crowd waited for the players to re-appear for their lap of honour, and largely heeded the appeals not to encroach on to the pitch.

It certainly was a great occasion for the Club, and the fore-runner, we hope, of many more successes in the future.

However, the end of the season is not with us yet and we are expecting another stern task this afternoon when Bradford City, who are still intimately interested in the promotion issue, are our visitors.

This should be a most attractive game because the City are one of only five teams who have beaten us this season.

That was way back at Valley Parade in December and it is an odd circumstance that one of our other set-backs also came in that city.

Target now, for Allan Brown is to set up a new points for the Fourth Division which looks a feasible proposition because three points from the three remaining matches will accomplish this.

Next Saturday, we go to Crewe and our season ends the following week with the visit of Brentford, which will be another big occasion because this will mark the presentation by the League of the Division IV trophy.

Doubtless, most of those who watched Wednesday's brilliant display will want to share in our glory when the presentation is made.

On sale at this match will be a specially compiled, glossy souvenir brochure which is the only official one available—price 2/6.

TODAY'S PIC



BOB READHEAD

LUTON TOWN FOOTBALL CLUB POOL

BINGO

£60—Full House in 40 Numbers or Less

£40—Full House in 44 Numbers or Less

£25—Full House in 50 Numbers or Less

£25—Full House in 54 Numbers or Less

NUMBERS PRINTED DAILY in DAILY SKETCH AND ALL LOCAL PAPERS

LUTON TOWN IMPROVEMENT FUND—Week 1

| | £15 | £5 | £5 | £2 | £2 | £2 |
|-----------|-------|-------|-------|-------|-------|-------|
| Monday | 21382 | 03356 | 19248 | 13203 | 09652 | 11171 |
| Tuesday | 18469 | 15693 | 00534 | 08868 | 12047 | 15439 |
| Wednesday | 20468 | 06555 | 10833 | 22608 | 07026 | 01673 |
| Thursday | 09128 | 14323 | 05735 | 17150 | 10594 | 18682 |
| Friday | 00988 | 19071 | 16904 | 02603 | 21460 | 06198 |

WINNING CAR NUMBERS—Week 7 Mauve—17111—If not claimed within 14 days
Week 5 Moss Green—11835 or Week 10 Blue—25511 or Week 10 Blue—25559

W. CHAMBERLAIN

& CO., (LUTON) LTD.

VALSPAR

Lacquer and
Flat Wall Paint

SISSON'S

Siscolin Distemper

PARIPAN

Enamels and
Water Paint

General

Hardware

Merchants

★

ALL GARDEN
REQUISITES

106, Dunstable Road, Luton

Telephone 20329 Enquiries Invited

Keep Right on Top

'RONS' Gentlemen's
Hairdressers
and Stylists

6, MILL STREET, LUTON

Telephone: Luton 21961

Also at 127, High St, North, Dunstable

Telephone: Dunstable 62063

★ 7 CHAIRS OPERATING ★

INTERNATIONAL STAFF

SAM-PAN

Chinese Food to Take Away

16, Leagrave Road

LUTON

NOW OPEN

NOW OPEN

Week 1—Colour Green

PEN PORTRAITS OF OUR VISITORS

Jack Marsh (goalkeeper). Was signed as a full time professional in June 1966 at the age of 18. A native of Leeds, he joined City from a Leeds Junior side.

Alec Smith (full back). Was born at Thornhill Lees, Dewsbury, and joined City as a full time professional in December 1964 from Ossett Albion the Yorkshire League side.

Ian Cooper (full back). Bradford born a former Bradford and Yorkshire Boys player. Joined City as an amateur in September 1962, turning professional in August 1966.

Bruce Stowell (wing half). Another local and former Bradford Boys captain. The longest serving player on the books, but just become a full time professional, having spent 8½ seasons as a part timer whilst employed in the local Wool Trade.

Tom Hallett (centre half). Starting his second season with City whom he joined from Swindon Town in May 1966. Had been three seasons with Swindon Town and before that spent six years at Leeds United. Is a native of Glynneath (Glamorgan) and joined Leeds United from Swansea Juniors.

Barry Swallow (wing half). Secured from Barnsley at a small fee in February 1967 and was ever present for the remainder of the season. Previously with Crewe Alexandra and his native Doncaster Rovers whom he joined at the age of 16.

John Hall (winger). Had his most successful season in 1966/67 since turning professional in May 1962, scoring 17 goals in 44 League appearances. Was with Huddersfield Town as an amateur before joining City.

Jimmy McAnearney (inside forward). Hails from Dundee and had six seasons with Sheffield Wednesday before moving to Plymouth Argyle. Was transferred to Watford from whom City signed him in September 1966. Appointed player-coach in February 1967.

Charlie Rackstraw (centre forward). Born at Sheffield and played two seasons for Sheffield Schoolboys before joining

Chesterfield. Spent four seasons there before moving on to Gillingham from whom City signed him in January 1967, at a small fee.

Jimmy Cuthbertson (inside forward). A native of Silksworth near Sunderland. Played for Durham County Boys and on leaving school joined Dawdon Colliery Juniors. Came to Valley Parade in the 1964/65 season, and turned professional in the summer of 1966.

Geoffrey Carter (winger). Born at Moulton (Northants) and joined West Bromwich Albion from school in the 1959/60 season. Made his League debut that season and was transferred to Bury in 1966. Joined City in August 1967 for a trial period.

Wednesday, 1st May, 1968

North Home Counties Sunday Football—Final

BRACHE SPARTA v. DERNCLIFFE

Kick-off 7.30 p.m.

Saturday, 4th May, 1968

William Pease Jubilee Trophy—Final

BIRD IN HAND v. TAVERNERS

Kick-off 3 p.m.

Wednesday, 8th May, 1968

Bedfordshire Professional Cup—Final

LUTON TOWN v. BEDFORD TOWN

Kick-off 7.30 p.m.

TODAY'S FOOTBALL

was kindly donated by

THE
EVENING POST

TODAY'S LINE-UP

Luton Town

Colours—

White and Black

- | | |
|---------------|-------------------|
| 1. Read | Referee : |
| 2. Dougan | Mr. E. D. Wallace |
| 3. Jardine | (Swindon) |
| 4. Slough | Linesmen : |
| 5. Branston | Red Flag : |
| 6. Moore | Mr. S. F. Lover |
| 7. French | (Shooters Hill) |
| 8. Buxton | Orange Flag : |
| 9. Allen | Mr. G. F. Keep |
| 10. Rioch | (New Cross) |
| 11. Whittaker | |

SUBSTITUTE

12. McDerment

Bradford City

Colours—

Claret and Amber

- | |
|---------------|
| 1. Liney |
| 2. Atkins |
| 3. Cooper |
| 4. Stowell |
| 5. Hallett |
| 6. Swallow |
| 7. Hall |
| 8. Ham |
| 9. Leighton |
| 10. Rackstraw |
| 11. Walker |

SUBSTITUTE

12. Bannister

**WHITBREAD
TANKARD**
cool, refreshing flavour



GOOD EVENING FOOTBALL NEWS & COMMENT NIGHTLY

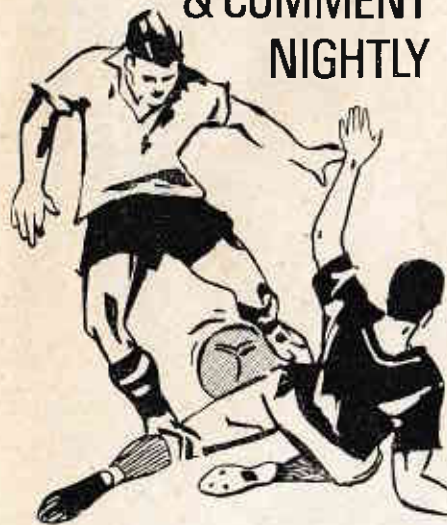

EVENING **POST**

**Twenty - One
Eighty - Seven
Three**

These three numbers appeal to me

Try them on the telephone
when you want a taxi home

Tel.: Luton **21873**

S.A.S. TAXI SERVICE

PRIVATE HIRE

For
good quality
printing
in 1968 at
reasonable
prices



COME TO

E. A. ALLEN & SON

(Luton) LTD. 'Phone: Luton 51626

Printers of Quality

2a, DOUGLAS ROAD

Printers of this Programme

**INDUSTRIAL and
HOME HEATING**

also all types of **ELECTRICAL
INSTALLATIONS**

CONSULT

**ENGINEERING
SERVICES** (LUTON)
LTD.

Arcade Chambers, 16a, Leys Avenue
Letchworth. 'Phone: Letchworth 5341

LUTON F.C. — for FOOTBALL

**COSTIN'S
FOR COACHES**

29 - 52 Seater Luxury Coaches for
Private Hire

Excursions to away fixtures

G. E. COSTIN Ltd.

67, West Street, Dunstable

'Phone 64331

LEAGUE MATCHES—Players' Appearances and Goal Scorers

| Names | APPEARANCES | | | GOALS | | |
|---------------|-------------|----------|----------|----------|----------|----------|
| | 1st Team | 2nd Team | 'A' Team | 1st Team | 2nd Team | 'A' Team |
| K. ALLEN | 41 | ... | ... | 14 | ... | ... |
| K. BEAVEN | 1 | 7 | 25 | ... | ... | 6 |
| T. BRANSTON | 42 | ... | ... | 5 | ... | ... |
| M. BROWN | 12 | 20 | ... | 2 | 10 | ... |
| I. BUXTON | 34 | ... | ... | 13 | ... | ... |
| P. DENTON | 4 | 10 | ... | ... | 3 | ... |
| M. DOUGAN | 36 | 1 | ... | ... | ... | ... |
| G. FRENCH | 27 | 3 | ... | 5 | ... | ... |
| T. HARE | 12 | 21 | ... | ... | ... | ... |
| R. GREEN | 9 | 18 | ... | 3 | 17 | ... |
| F. JARDINE | 37 | ... | ... | ... | ... | ... |
| B. JOHNSON | 2 | 12 | ... | ... | ... | ... |
| B. McDERMENT | 19 | 12 | ... | ... | ... | ... |
| P. MOONEY | ... | 19 | 30 | ... | 2 | 2 |
| J. MOORE | 41 | ... | ... | 3 | ... | ... |
| T. READ | 39 | 1 | ... | ... | ... | ... |
| B. RIOCH | 40 | ... | ... | 20 | ... | ... |
| N. RIOCH | ... | 24 | 29 | ... | ... | 5 |
| J. RYAN | 10 | 17 | ... | 1 | 3 | ... |
| A. SLOUGH | 31 | 4 | ... | 5 | 1 | ... |
| A. STARLING | ... | 3 | 25 | ... | ... | ... |
| W. TAYLOR | 3 | 13 | ... | ... | ... | ... |
| R. WAINWRIGHT | ... | 19 | 28 | ... | 6 | 16 |
| R. WHITTAKER | 34 | ... | ... | 8 | ... | ... |
| TRIALISTS | 8 | 41 | ... | ... | 5 | ... |
| AMATEURS | ... | 33 | 205 | ... | 2 | 16 |
| OPPONENTS | ... | ... | ... | ... | ... | ... |

One Kick
and your'e away
on a
VESPA

from
**GRAYMAC
AUTOS LTD.**
Dunstable Place
LUTON
THE
Vespa People
LUTON 31381

THE
Old Bell
HARPENDEN
(FULLY LICENCED)



Proprietor:
TOM HODGSON
Ex-Captain Luton Town F.C.
LARGE CAR PARK

BEIDS
Chemists
(LUTON) LTD.

For ALL your
Pharmaceutical
Toilet and
Photographic
Requirements

169 Dunstable Rd.
LUTON
Corner of Kenilworth Rd.
Phone - LUTON 21760



VISIT

CÉSAR'S
**LUTONS LEADING
NIGHT SPOT**
**DANCING
DINING
CASINO**

LATE LICENCE
UNTIL 2 a.m.

Telephone
LUTON 51357 for
Membership
application form and
details of forthcoming
attractions

TOP STAR CABARET
APRIL 28th to May 2nd

LIONEL BLAIR
and his
Entire Show

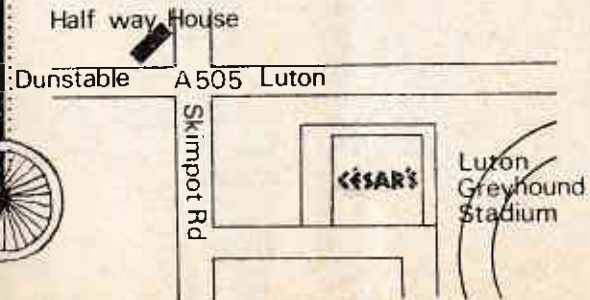

Today's Half-Time Scores

NOTE. The letter in the Programme corresponds with the letter on the Board—thus A 0-1 means that the first named club has scored 0 and their opponents 1

FIRST LIST

F.A. CHALLENGE CUP — Semi-Finals

| | | | |
|---|------------|--------------|-------|
| A | Birmingham | West Brom. | |
| B | Everton | Leeds United | |

LEAGUE MATCHES

| | | | |
|---|----------------|----------------|-------|
| C | Arsenal | Burnley | |
| D | Chelsea | Sunderland | |
| E | Coventry City | Leicester City | |
| F | Liverpool | Fulham | |
| G | Newcastle U. | Tottenham H. | |
| H | Sheffield Utd. | West Ham U. | |
| K | Southampton | Wolves | |
| L | Blackburn R. | Cardiff City | |
| M | Blackpool | Portsmouth | |
| N | Bolton Wan. | Crystal Palace | |

SECOND LIST

| | | | |
|---|---------------|---------------|-------|
| A | Bristol City | Preston N. E. | |
| B | Carlisle Utd. | Plymouth A. | |
| C | Ipswich T. | Q.P.R. | |
| D | Middlesboro' | Derby | |
| E | Millwall Ath. | Norwich City | |
| F | Brighton | Barrow | |
| G | Gillingham | Mansfield T. | |
| H | Grimsby T. | Watford | |
| K | Northampton | Colchester U. | |
| L | Orient | Bournemouth | |
| M | Reading | Scunthorpe | |
| N | Swindon T. | Oldham Ath. | |

THIRD LIST

| | | | |
|---|-------------|--------------|-------|
| A | Walsall | Peterborough | |
| B | Bradford | Lincoln City | |
| C | Newport Co. | Exeter City | |
| D | Rochdale | Aldershot | |
| E | Swansea T. | Chester | |
| F | Wrexham | Notts. Co. | |

SCOTTISH CUP FINAL

| | | | |
|---|-------------|--------|-------|
| G | Dunfermline | Hearts | |
| H | | | |
| K | | | |
| L | | | |
| M | | | |
| N | | | |

League Tables 1967-68

FOOTBALL LEAGUE — DIVISION FOUR

Up to and including Wednesday, 24th April, 1968

| | P | W | D | L | F | A | Pts |
|----------------------|----|----|----|----|----|----|-----|
| LUTON TOWN | 43 | 26 | 12 | 5 | 83 | 38 | 64 |
| Barnsley | 43 | 22 | 12 | 9 | 61 | 43 | 56 |
| Crewe Alexandra | 44 | 19 | 17 | 8 | 72 | 48 | 55 |
| BRADFORD CITY | 44 | 22 | 10 | 12 | 68 | 48 | 54 |
| Hartlepoons Utd. | 42 | 23 | 9 | 11 | 54 | 45 | 53 |
| Chesterfield | 44 | 20 | 11 | 13 | 67 | 47 | 51 |
| Southend United | 42 | 19 | 13 | 10 | 71 | 52 | 51 |
| Aldershot | 43 | 16 | 16 | 11 | 63 | 51 | 48 |
| Wrexham | 42 | 17 | 12 | 13 | 65 | 51 | 46 |
| Doncaster Rov. | 42 | 16 | 13 | 13 | 61 | 55 | 45 |
| Brentford | 43 | 17 | 8 | 18 | 58 | 58 | 42 |
| Newport County | 42 | 15 | 12 | 15 | 53 | 56 | 42 |
| Halifax Town | 41 | 13 | 15 | 13 | 49 | 46 | 41 |
| Swansea Town | 42 | 15 | 10 | 17 | 61 | 70 | 40 |
| Lincoln City | 43 | 14 | 10 | 19 | 63 | 64 | 38 |
| Darlington | 43 | 11 | 15 | 17 | 45 | 52 | 37 |
| Port Vale | 42 | 11 | 14 | 17 | 59 | 68 | 36 |
| Notts County | 41 | 12 | 11 | 18 | 47 | 72 | 35 |
| York City | 42 | 11 | 12 | 19 | 59 | 59 | 34 |
| Rochdale | 42 | 10 | 14 | 18 | 47 | 66 | 34 |
| Exeter City | 42 | 11 | 12 | 19 | 44 | 64 | 33 |
| Chester | 43 | 9 | 13 | 21 | 56 | 75 | 31 |
| Workington | 42 | 9 | 11 | 22 | 51 | 82 | 29 |
| Bradford | 41 | 4 | 14 | 23 | 29 | 73 | 22 |

LONDON MID - WEEK LEAGUE

Up to and including Wednesday, 3rd April, 1968

| | P | W | D | L | F | A | Pts |
|-------------------|----|----|---|----|----|----|-----|
| Watford | 25 | 11 | 6 | 8 | 61 | 47 | 28 |
| Millwall Athletic | 22 | 9 | 7 | 6 | 52 | 41 | 25 |
| Aldershot | 23 | 12 | 1 | 10 | 42 | 45 | 25 |
| Charlton Ath. | 26 | 9 | 7 | 10 | 47 | 65 | 25 |
| Q.P.R. | 24 | 9 | 6 | 9 | 52 | 47 | 24 |
| Colchester Utd. | 23 | 8 | 6 | 9 | 45 | 45 | 22 |
| LUTON TOWN | 24 | 10 | 2 | 12 | 45 | 53 | 22 |
| Southend United | 25 | 8 | 5 | 12 | 50 | 51 | 21 |

SOUTH EAST COUNTIES LEAGUE

Up to and including Saturday, April 20th, 1968

| | P | W | D | L | F | A | Pts |
|-------------------|----|----|----|----|----|-----|-----|
| Q.P.R. | 27 | 22 | 2 | 3 | 89 | 36 | 46 |
| Orient | 27 | 19 | 4 | 4 | 92 | 34 | 42 |
| Chelsea | 26 | 18 | 3 | 5 | 80 | 43 | 39 |
| Tottenham Hotspur | 28 | 16 | 4 | 8 | 78 | 45 | 36 |
| Charlton Athletic | 27 | 15 | 5 | 7 | 67 | 43 | 35 |
| West Ham United | 27 | 13 | 8 | 6 | 72 | 47 | 34 |
| Ipswich Town | 28 | 17 | 2 | 9 | 65 | 30 | 34 |
| Crystal Palace | 28 | 15 | 2 | 11 | 75 | 70 | 32 |
| Millwall Athletic | 27 | 10 | 9 | 8 | 63 | 37 | 29 |
| Brighton | 28 | 8 | 6 | 14 | 58 | 87 | 22 |
| Fulham | 28 | 8 | 4 | 16 | 38 | 76 | 20 |
| LUTON TOWN | 29 | 7 | 4 | 18 | 45 | 93 | 18 |
| Watford | 28 | 3 | 11 | 14 | 41 | 59 | 17 |
| Oxford United | 28 | 6 | 3 | 19 | 42 | 90 | 15 |
| Gillingham | 28 | 3 | 6 | 19 | 37 | 77 | 12 |
| Bexley United | 26 | 2 | 3 | 21 | 34 | 109 | 7 |

Division 4 and London Mid-Week League Fixtures : 1967 - 68

| 1967 | First XI, Div. 4 | Attendance | F | A |
|---------|-------------------------|------------|---|-----|
| Aug. 19 | Sat. Wrexham | 9514 | A | 1 1 |
| .. 26 | Sat. Barnsley | 7887 | H | 2 0 |
| Sept. 2 | Sat. Swansea Town | 6674 | A | 2 2 |
| .. 4 | Mon. Southend United | 11355 | A | 0 3 |
| .. 9 | Sat. Hartlepoons Utd. | 8347 | H | 1 0 |
| .. 16 | Sat. Newport County | 4625 | A | 1 1 |
| .. 23 | Sat. York City | 7977 | H | 3 1 |
| .. 27 | Wed. Southend United | 13332 | H | 3 1 |
| .. 30 | Sat. Rochdale | 1884 | A | 2 2 |
| Oct. 3 | Tu. Doncaster Rovers | 5529 | A | 0 2 |
| .. 7 | Sat. Chester | 3967 | A | 3 1 |
| .. 14 | Sat. Chesterfield | 10441 | H | 1 0 |
| .. 21 | Sat. Exeter City | 3434 | A | 5 0 |
| .. 25 | Wed. Doncaster Rovers | 13925 | H | 5 3 |
| Nov. 11 | Sat. Workington | 10935 | H | 4 0 |
| .. 15 | Wed. Swansea Town | 14975 | H | 4 0 |
| .. 18 | Sat. Lincoln City | 6052 | A | 3 2 |
| .. 25 | Sat. Halifax Town | 11572 | H | 2 0 |
| Dec. 2 | Sat. Bradford City | 7957 | A | 0 2 |
| .. 14 | Th. Oxford C. (Cup 1) | 13394 | A | 2 1 |
| .. 16 | Sat. Wrexham | 9598 | H | 2 1 |
| .. 23 | Sat. Barnsley | 8704 | A | 2 2 |
| .. 26 | Tu. Bradford | 16699 | H | 2 0 |
| .. 30 | Sat. Bradford | 3674 | A | 1 2 |
| 1968 | | | | |
| Jan. 6 | Sat. Cup 2—Swindon | 18203 | A | 2 3 |
| .. 13 | Sat. Hartlepoons Utd. | 4728 | A | 1 2 |
| .. 20 | Sat. Newport County | 10992 | H | 1 1 |
| .. 27 | Sat. Port Vale (3) | 5970 | A | 0 0 |
| Feb. 3 | Sat. York City | 2747 | A | 1 1 |
| .. 10 | Sat. Rochdale | 10040 | H | 4 1 |
| .. 17 | Sat. Brentford (4) | 7752 | A | 2 0 |
| .. 24 | Sat. Lincoln City | 11159 | H | 4 2 |
| .. 26 | Mon. Darlington | 13948 | H | 3 1 |
| Mar. 2 | Sat. Chesterfield | 14075 | A | 0 0 |
| .. 9 | Sat. Port Vale (5) | 12749 | H | 2 0 |
| .. 16 | Sat. Exeter City | 12409 | H | 0 0 |
| .. 20 | Wed. Aldershot | 9724 | A | 1 0 |
| .. 23 | Sat. Darlington | 4336 | A | 2 1 |
| .. 30 | Sat. Aldershot (6) | 10618 | H | 3 1 |
| April 6 | Sat. Workington | 2195 | A | 1 0 |
| .. 12 | Fri. Notts County | 16631 | H | 2 0 |
| .. 13 | Sat. Chester | 13266 | H | 0 0 |
| .. 15 | Mon. Notts County | 7920 | A | 2 2 |
| .. 20 | Sat. Halifax Town | 5091 | A | 1 0 |
| .. 24 | Wed. Crewe Alexandra | 18904 | H | 4 0 |
| .. 27 | Sat. Bradford C. (S.F.) | | H | |
| May 4 | Sat. Crewe Alexandra | | A | |
| .. 11 | Sat. Brentford | | H | |
| .. 18 | Sat. F.A. Cup (Final) | | | |

| 1967 | London Mid - Week League | Attendance | F | A |
|---------|--------------------------|------------|---|-----|
| Aug. 30 | Wed. Colchester United | | A | 0 1 |
| Sept. 6 | Wed. Colchester United | 332 | H | 1 0 |
| .. 20 | Wed. Watford | 465 | H | 1 4 |
| Oct. 11 | Wed. Millwall Athletic | | A | 1 3 |
| .. 18 | Wed. Charlton Athletic | 627 | H | 6 2 |
| Nov. 7 | Tues. Charlton Athletic | | A | 1 3 |
| .. 22 | Wed. Southend United | 997 | H | 2 3 |
| .. 28 | Tues. Watford | | A | 1 5 |
| Dec. 6 | Wed. Q. P. R. | 332 | H | 2 5 |
| .. 19 | Tues. Q. P. R. | | A | 3 4 |
| 1968 | | | | |
| Jan. 17 | Wed. Colchester United | | A | 2 1 |
| .. 24 | Wed. Aldershot | 586 | H | 3 0 |
| .. 29 | Mon. Southend United | | A | 1 5 |
| .. 31 | Wed. Colchester United | 718 | H | 3 0 |
| Feb. 7 | Wed. Millwall Athletic | | A | 0 4 |
| .. 12 | Mon. Aldershot | 429 | H | 2 1 |
| .. 14 | Wed. Q. P. R. | 805 | H | 3 2 |
| .. 20 | Tues. Charlton Athletic | | A | 1 2 |
| .. 28 | Wed. Charlton Athletic | 428 | H | 1 0 |
| Mar. 5 | Tues. Q. P. R. | | A | 3 1 |
| .. 7 | Th. Aldershot | | A | 2 3 |
| .. 13 | Wed. Watford | 440 | H | 2 0 |
| .. 27 | Wed. Southend United | 686 | H | 2 2 |
| Apr. 3 | Wed. Southend United | | A | 2 2 |
| .. 10 | Wed. Millwall Athletic | 585 | H | 4 0 |
| .. 30 | Tues. Watford | | A | |
| May 2 | Thur. Aldershot | | A | |
| .. 6 | Mon. Millwall Athletic | | H | |

The figures 1, 2, 3, 4, 5, 6, refer to Cup Tie Dates
Copyright of the Football League Limited 1967

NEXT MATCHES

Monday, 6th May, 1968

London Mid Week League Kick-off 7.30 p.m.

Luton Town Reserves

Millwall Reserves

PRICES OF ADMISSION
Grandstand and Enclosure Only
Adults 2/6 Children 1/6 Centre Stand 6d. extra

Saturday, 11th May, 1968

Football League — Division 4 Kick-off 3 p.m.

LUTON TOWN

BRENTFORD

PRICES OF ADMISSION : Centre Stand 7/6
Wing Stand 6/- Enclosure 5/- Boys 2/6
Bobbers Stand 4/- Boys 2/- Terraces 4/- Boys 2/-

WILDS OF LUTON LIMITED

8-10, BUTE STREET, LUTON. Tel. 23671

WILDS OF DUNSTABLE LIMITED

41, HIGH STREET NORTH, DUNSTABLE. Tel. 63275

WILDS OF BEDFORD LIMITED

7, HIGH STREET, BEDFORD. Tel. 59834

Suppliers to—

LUTON TOWN F.C. : BEDFORD TOWN F.C.
and other Premier Clubs in the County

*Now is the time to buy
your Summer Sports Equipment*

We have our new season stocks available of—

CRICKET, TENNIS and BOWLS CLOTHING—FOOTWEAR and EQUIPMENT
our Representative will call and see Club Secretaries (generous Club terms)
why wait and possibly pay more Purchas Tax

Our 1968 Camping Catalogues now available

Come and discuss your requirements with our experts.

Immediate H.P. Credit facilities to approved clients

We can erect any Tent for your consideration

RIDGE TENTS from £3/0/0

FRAME TENTS (to sleep 4) from £35/10/0

Come and see the famous—

SWEDISH "PALMA DEL SOL" FRAME TENT—EXCEPTIONAL VALUE

Limited quantity imported. Now on show in our Luton shop

SLEEPING BAGS, TABLES, CHAIRS, COOKING STOVES, AIR BEDS, CAMP
BEDS—Everything for the Family or Hike Camper

Note the dates of our Camping Exhibitions

College of Aeronautics, Cranfield—B.557 (2 miles off M.1.)

Friday, April 12th (Good Friday) to Sunday, 28th April

Laporte's Sports Ground, Luton Road, Dunstable

Friday, 3rd May to Sunday, 19th May

Kensworth Sports Ground—off A5 to Whipsnade Zoo

Friday 24th May to Sunday, 9th June

Stotfold Football Ground, Stotfold, Beds.— $\frac{1}{2}$ mile off A1

Friday, 14th June to Sunday, 30th June